

Uninsulated Copper Brazed Sheet Terminals

Eland Product Group **FCA**



Application

Used when the fixing hole size required is too big for the specified lug.

Standards

DIN 46234

Dimensions

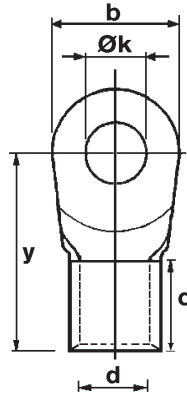

Eland Part Number	Cable Size mm ²	Stud Size mm	d mm	y mm	b mm	c mm	Øk mm	Pack Quantity
FBY1M27D	0.5 - 1.5	2.4	1.6	10.8	6.0	4.8	2.7	100
FBY1M32D	0.5 - 1.5	3.0	1.6	10.8	6.0	4.8	3.2	100
FBY1M37D	0.5 - 1.5	3.5	1.6	10.8	6.0	4.8	3.7	100
FBY1M43D	0.5 - 1.5	4.0	1.6	11.8	8.0	4.8	4.3	100
FBY1M53D	0.5 - 1.5	5.0	1.6	12.8	10.0	4.8	5.3	100
FBY1M65D	0.5 - 1.5	6.0	1.6	14.8	11.0	4.8	6.5	100
FBY25M32D	1.5 - 2.5	3.0	2.3	10.8	6.0	4.8	3.2	100
FBY25M37D	1.5 - 2.5	3.5	2.3	10.8	6.0	4.8	3.7	100
FBY25M43D	1.5 - 2.5	4.0	2.3	11.8	8.0	4.8	4.3	100
FBY25M53D	1.5 - 2.5	5.0	2.3	13.8	10.0	4.8	5.3	100
FBY25M65D	1.5 - 2.5	6.0	2.3	15.8	11.0	4.8	6.5	100
FBY25M84D	1.5 - 2.5	8.0	2.3	16.8	14.0	4.8	8.4	100
FBY6M43D	4.0 - 6.0	4.0	3.6	14.0	8.0	6.0	4.3	50
FBY6M53D	4.0 - 6.0	5.0	3.6	15.0	10.0	6.0	5.3	50
FBY6M65D	4.0 - 6.0	6.0	3.6	16.0	11.0	6.0	6.5	50
FBY6M84D	4.0 - 6.0	8.0	3.6	19.0	14.0	6.0	8.4	50
FBY6M105D	4.0 - 6.0	10.0	3.6	21.0	18.0	6.0	10.5	50
FBY4-10*	10.0	4.0	4.5	16.0	10.0	8.0	4.3	50

Eland Part Number	Cable Size mm ²	Stud Size mm	d mm	y mm	b mm	c mm	Øk mm	Pack Quantity
FBY5-10	10.0	5.0	4.5	16.0	10.0	8.0	5.3	50
FBY6-10	10.0	6.0	4.5	17.0	11.0	8.0	6.5	50
FBY8-10	10.0	8.0	4.5	20.0	14.0	8.0	8.4	50
FBY10-10	10.0	10.0	4.5	21.0	18.0	8.0	10.5	50
FBY12-10	10.0	12.0	4.5	23.0	22.0	8.0	13.0	50
FBY5-16	16.0	5.0	5.8	20.0	11.0	10.0	5.3	50
FBY6-16	16.0	6.0	5.8	20.0	11.0	10.0	6.5	50
FBY8-16	16.0	8.0	5.8	22.0	14.0	10.0	8.4	50
FBY10-16	16.0	10.0	5.8	24.0	18.0	10.0	10.5	50
FBY12-16	16.0	12.0	5.8	26.0	22.0	10.0	13.0	50
FBY5-25	25.0	5.0	7.5	25.0	12.0	11.0	5.3	50
FBY6-25	25.0	6.0	7.5	25.0	12.0	11.0	6.5	50
FBY8-25	25.0	8.0	7.5	25.0	16.0	11.0	8.4	50
FBY10-25	25.0	10.0	7.5	26.0	18.0	11.0	10.5	50
FBY12-25	25.0	12.0	7.5	31.0	22.0	11.0	13.0	50
FBY14-25*	25.0	14.0	7.5	31.0	22.0	11.0	15.0	50
FBY16-25	25.0	16.0	7.5	35.0	28.0	11.0	17.0	50
FBY6-35	35.0	6.0	9.0	26.0	15.0	12.0	6.5	50
FBY8-35	35.0	8.0	9.0	26.0	16.0	12.0	8.4	50
FBY10-35	35.0	10.0	9.0	27.0	18.0	12.0	10.5	50
FBY12-35	35.0	12.0	9.0	31.0	22.0	12.0	13.0	50
FBY14-35*	35.0	14.0	9.0	31.0	22.0	12.0	15.0	50
FBY16-35	35.0	16.0	9.0	35.0	28.0	12.0	17.0	50
FBY6-50	50.0	6.0	11.0	34.0	18.0	16.0	6.5	50
FBY8-50	50.0	8.0	11.0	34.0	18.0	16.0	8.4	50
FBY10-50	50.0	10.0	11.0	34.0	18.0	16.0	10.5	50
FBY12-50	50.0	12.0	11.0	36.0	22.0	16.0	13.0	50
FBY14-50*	50.0	14.0	11.0	36.0	22.0	16.0	15.0	50
FBY16-50	50.0	16.0	11.0	40.0	22.0	16.0	17.0	50
FBY8-70	70.0	8.0	13.0	38.0	22.0	18.0	8.4	25
FBY10-70	70.0	10.0	13.0	38.0	22.0	18.0	10.5	25
FBY12-70	70.0	12.0	13.0	38.0	22.0	18.0	13.0	25
FBY14-70*	70.0	14.0	13.0	38.0	22.0	18.0	15.0	25
FBY16-70	70.0	16.0	13.0	42.0	28.0	18.0	17.0	25
FBY10-95	95.0	10.0	15.0	42.0	24.0	20.0	10.5	25
FBY12-95	95.0	12.0	15.0	42.0	24.0	20.0	13.0	25
FBY14-95*	95.0	14.0	15.0	42.0	24.0	20.0	15.0	25
FBY16-95	95.0	16.0	15.0	44.0	28.0	20.0	17.0	25
FBY10-120	120.0	10.0	16.5	44.0	24.0	22.0	10.5	25
FBY12-120	120.0	12.0	16.5	44.0	24.0	22.0	13.0	25
FBY14-120*	120.0	14.0	16.5	44.0	24.0	22.0	15.0	25
FBY16-120	120.0	16.0	16.5	48.0	28.0	22.0	17.0	25
FBY10-150	150.0	10.0	19.0	50.0	30.0	24.0	10.5	10
FBY12-150	150.0	12.0	19.0	50.0	30.0	24.0	13.0	10
FBY14-150*	150.0	14.0	19.0	50.0	30.0	24.0	15.0	10
FBY16-150	150.0	16.0	19.0	50.0	30.0	24.0	17.0	10
FBY12-185	185.0	12.0	21.0	50.0	36.0	28.0	13.0	10
FBY14-185*	185.0	14.0	21.0	50.0	36.0	28.0	15.0	10
FBY16-185	185.0	16.0	21.0	50.0	36.0	28.0	17.0	10
FBY12-240	240.0	12.0	23.5	56.0	38.0	32.0	13.0	10
FBY14-240*	240.0	14.0	23.5	56.0	38.0	32.0	15.0	10
FBY16-240	240.0	16.0	23.5	56.0	38.0	32.0	17.0	0

The information contained within this datasheet is for guidance only – actual cable dimensions should be considered before making final selection as these may vary due to manufacturing tolerances.